

Student name _____

Period _____

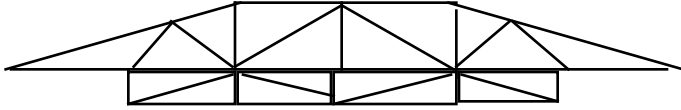

=====

Answer the following questions in the blank space provided.

- _____ 1. Because there were no bridges, people heading West in the 1850's had to ***** rivers in their covered wagons.
- _____ 2. The earliest bridge was one probably made from a ***.
- _____ 3. Primitive people as well as modern man still build bridges by simply using a cable or **** stretched across a river.
- _____ There is a Sophisticated rope bridge in China which is ***** feet long.
- _____ 4. This type of bridge is suitable only for light loads . Imagine what it would be like to cross this bridge in high ****.
- _____ 5. One if not the strongest bridge designs and the most durable is a **** bridge.
- _____ 6. The Romans built one that is still standing today. It was built nearly ***** years ago during the time of the Roman Empire.
- _____ 7. With the Discovery of IRON and later STEEL, bridges could now cover greater spans than stone arch bridges. Figure 5 has a span of ***** feet long.
- _____ , _____ 8. This steel bridge is a combination of ****, ****, and **** bridge.
- _____
- _____ 9. Steel bridges must be built with their steel arch in ***** and their steel cables in *****to hold up the roadbed.
- _____
- _____ 10. A cable is made up of several ***** to gain greater strength and flexibility.
- _____ 11. A type of bridge that is built towards the center of a river from each bank is normally a ***** bridge.
- _____ 12. In order to lift the center section of a Cantilever bridge into place you must use *****.
- _____ 13. Most simple wooden bridges are a **** design called a **** bridge .
- _____
- _____ 14. Bridges that could not span over wide rivers but could be built quickly and support great loads. This type of bridge was known as **** bridges.